

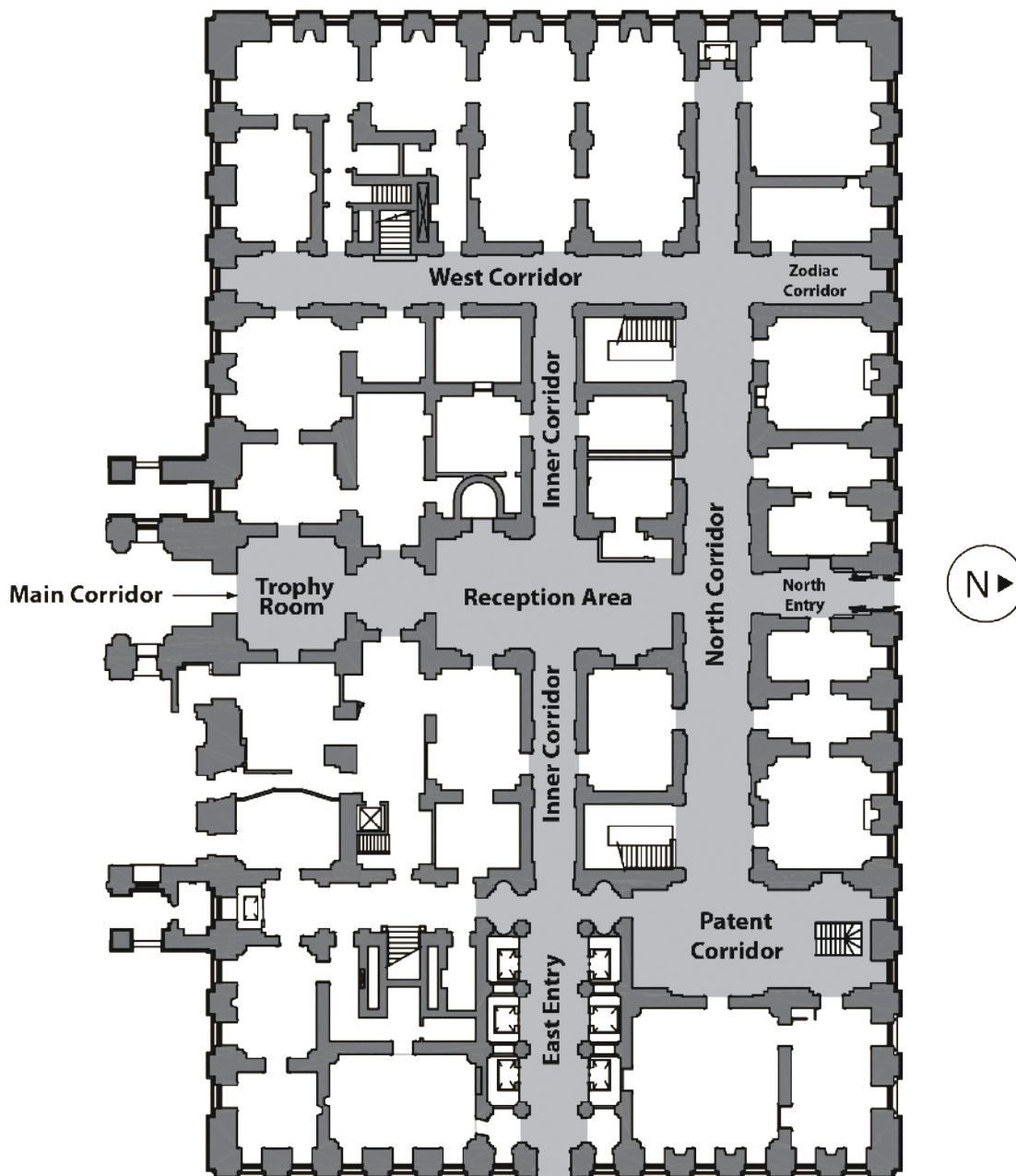

Appendices



APPENDIX A—FLOOR PLAN OF THE BRUMIDI CORRIDORS, SENATE WING, U.S. CAPITOL



Architect of the Capitol

Opposite: Bronze railing (detail), designed by Brumidi and sculpted by Edmond Baudin, Brumidi Corridors (East Stairway), 1858–59.

APPENDIX B—MAP OF THE PACIFIC RAILROAD SURVEY ROUTES INDICATING LOCATIONS
DEPICTED IN CONSTANTINO BRUMIDI’S LANDSCAPE MEDALLIONS

Constantino Brumidi modeled eight landscape medallions in the Brumidi Corridors after illustrations in the 12-volume *Pacific Railroad Report*. The potential routes surveyed in 1853–54 for the first transcontinental railroad are noted in red; the numbered locations correspond to Brumidi’s medallions (opposite page).

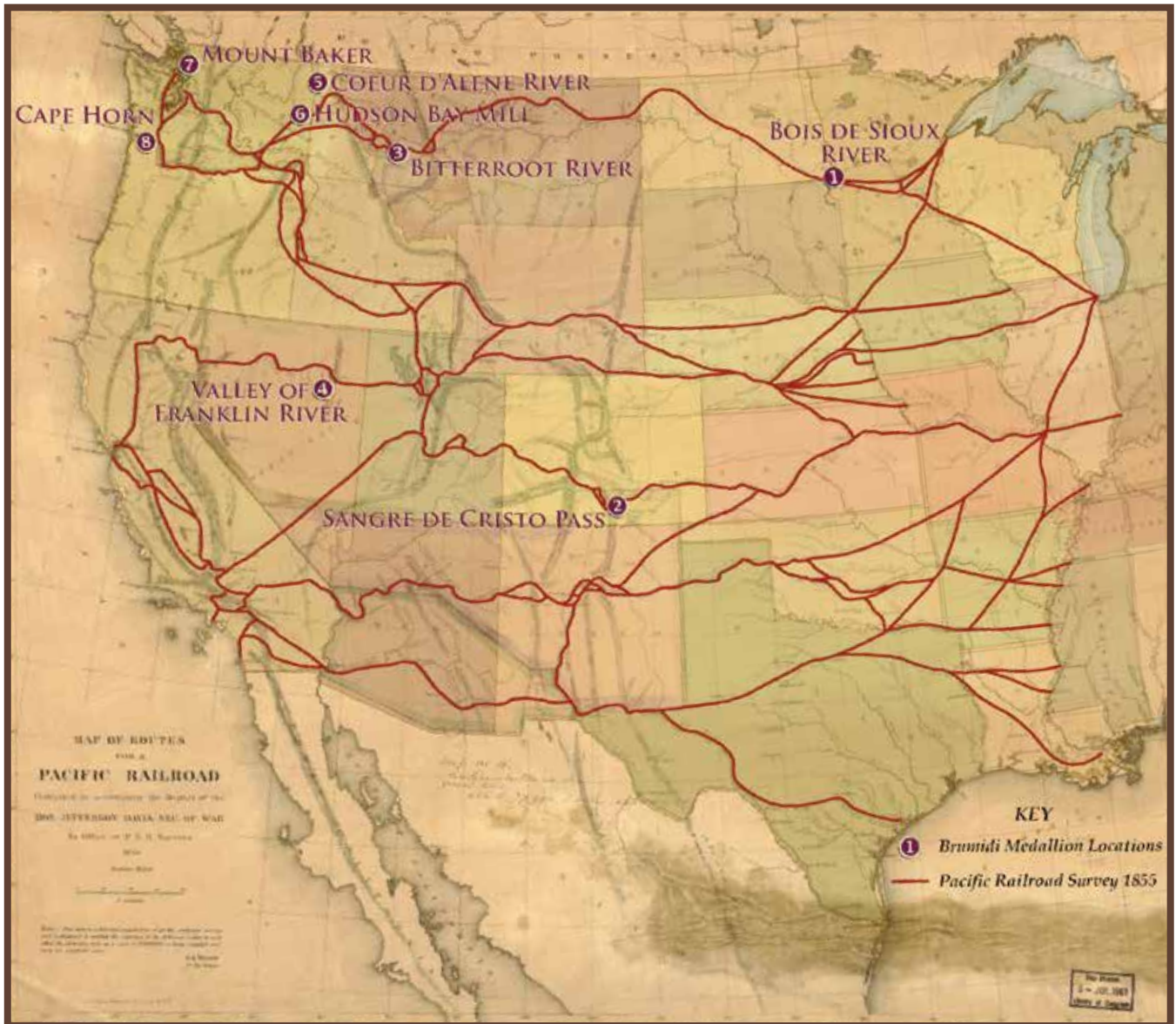

Adapted from G.K. Warren's 1855 *Map of Routes for a Pacific Railroad* (for original map, see page 59).

Library of Congress Geography and Map Division, Congressional Cartography Program



Bois de Sioux River (Minnesota)



Sangre de Cristo Pass (Colorado)



Bitterroot River (Montana)



Valley of Franklin River (Nevada)



Coeur d'Alene River (Idaho)



Hudson Bay Mill (Washington)



Mount Baker (Washington)



Cape Horn (Washington)