

NOTE: THIS DRAWING IS THE PROPERTY OF THE U.S. GOVERNMENT AND IS TO BE REPRODUCED IN WHOLE OR IN PART BY ANY PERSON OR ORGANIZATION WITHOUT PERMISSION OF THE U.S. GOVERNMENT. IT IS TO BE USED FOR THE PURPOSES AND IN THE MANNER SPECIFIED IN THE CONTRACT AND NOT BE LOANED, REPRODUCED, COPIED, OR IN ANY MANNER DISSEMINATED TO OTHERS WITHOUT THE WRITTEN PERMISSION OF THE U.S. GOVERNMENT. IT IS TO BE RETURNED TO THE U.S. GOVERNMENT UPON COMPLETION OF THE PROJECT OR AS OTHERWISE DIRECTED BY THE U.S. GOVERNMENT.

REV	DESCRIPTION	DATE	BY

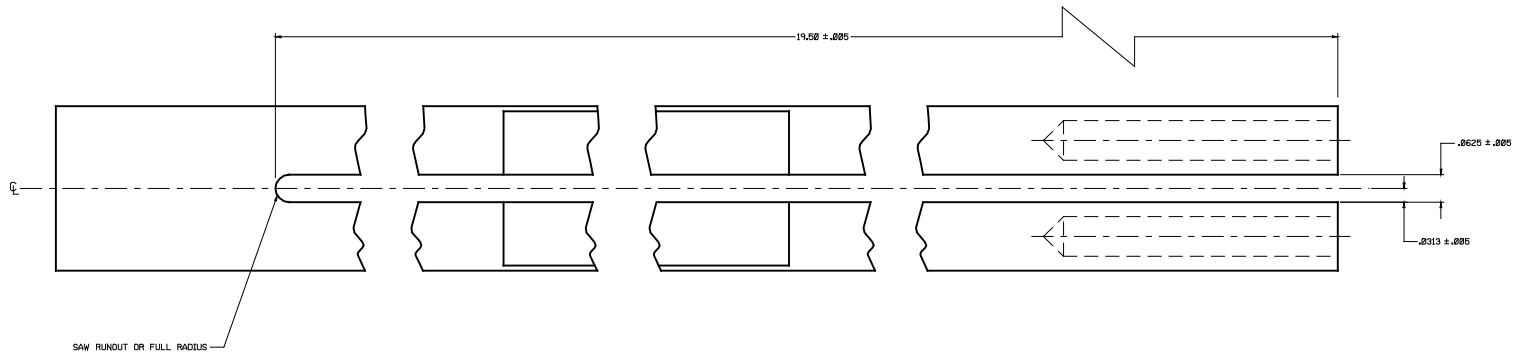
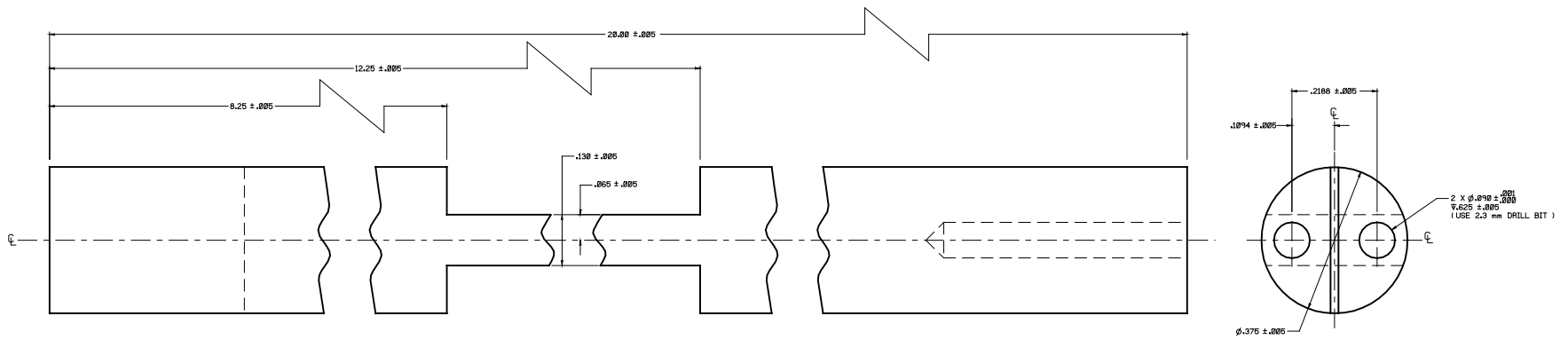

MACHINING DETAIL

SCALE: 10:1
MATERIAL: AXZ-50 CARBON

SK04062004

PRELIMINARY
HAS NOT COMPLETED REVIEW CYCLE
AND IS SUBJECT TO CHANGE
04-16-04

UNLESS OTHERWISE SPECIFIED	SEE THESE DRAWINGS	HEATER ELEMENT	SPECIAL TEST EQUIPMENT
DIMENSIONS AND DEVICES FRACTIONS: $\frac{1}{16}$ TO $\frac{3}{32}$ ± .005 DECIMALS: $\frac{1}{16}$ TO $\frac{3}{32}$ ± .005 DO NOT SCALE DRAWING	DIMENSIONS AND DEVICES DIMENSIONS AND DEVICES DIMENSIONS AND DEVICES DIMENSIONS AND DEVICES	GRAPHITE ROD	GEORGE C. NICHOLS & COMPANY SPACE FLIGHT CENTER 4100 UNIVERSITY AVENUE GREENSBORO, NC 27409
BUILDING: 4566	DATE: 04-06-04	DESIGNER: MRA	SK04062004
NOT APPROVED: FINAL	NOT APPROVED: JDD	NOT APPROVED: NOTED	NOT APPROVED: NOTED